

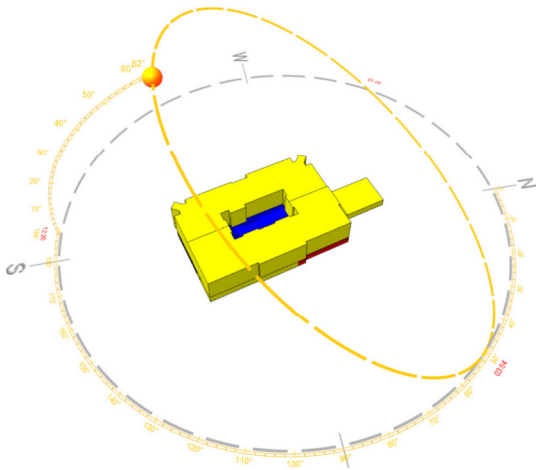

New endoscopy facility built within the existing West Block at Worthing Hospital, including infilling the existing courtyard. AMA scope included full MEP design duties.

Client: Kier / Western Sussex Hospitals NHS Trust
Value: £5 million
Date: 2015



Finding space for large air handling plant was a challenge, and there was limited ceiling void space available with existing live services. Routing of new M&E services required a high level of coordination.

AMA spent considerable time surveying to create accurate existing services drawings. This process helped to identify key enabling works required to maintain existing critical services during the works.



AMA method included IES thermal modelling to test ventilation design temperatures in terms of predicting resultant treatment room internal temperatures.

Key points:

- Thorough visual surveys carried out
- Investigation of existing infrastructure
- IES modelling of ventilation systems
- Detailed co-ordinated design with attention to detail



No 5 Level 5 (South)
New England House
New England Street
Brighton BN1 4GH
T +44 (0)1273 601759
F +44 (0)1273 604319

Argent House
Wild's Rents
London SE1 4QG
T +44 (0)20 7043 4634
F +44 (0)20 7378 0036